

# How to Attach Bird Abodes' Heavy-duty Porches to SuperGourds

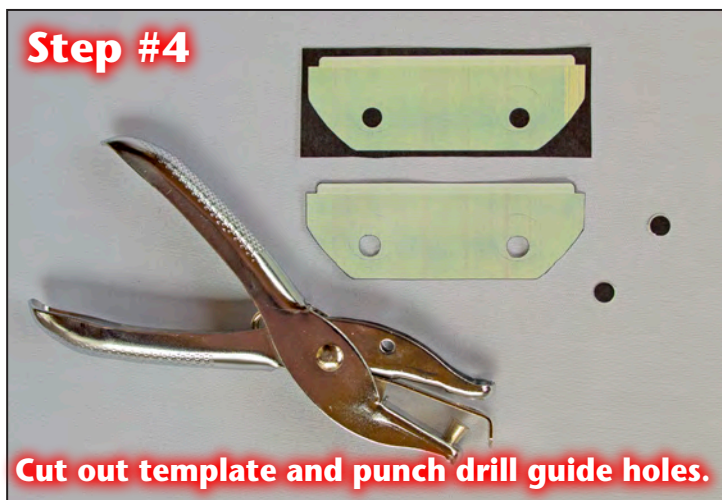

<https://www.facebook.com/SuperGourd>



## Installing Porches On Crescent SuperGourds

**Step #1:** Hold the base of a porch half up to the gourd so that it lies flush with the bottom of the entrance hole. If the bottom lip of the crescent bows in at all (as in this photo) proceed to step #2, otherwise skip to step #3. Most gourds are fine and don't need bent out.

**Step #2:** Straighten any inward bow of the crescent by grabbing it in several places with pliers (as shown) and bending it outward multiple times. The plastic will permanently hold the new position.

**Step #3:** Some newer crescent-holed SuperGourds come with drill guide holes molded in, as in the photo above left.

If your crescent-holed SuperGourds have these helpful, drill point guides, skip to step #6. If not, go to step #4.

**Step #4:** Using a pair of scissors, cut off the entire black perimeter of one of the identical templates supplied on page 5 of this pdf instruction sheet. The drill template is actually a life-size photo of the back of a porch. The width of the porch image should be 74 mm wide at its widest point, the same as an actual porch. If you download and print these plans from the internet, make certain your printer hasn't changed the size of the template before you drill your first gourd. Hold an actual porch up to the template and make sure the black drill guides line up exactly with the mounting holes in the base of the porch. Using a hole puncher, punch out the two black circles.

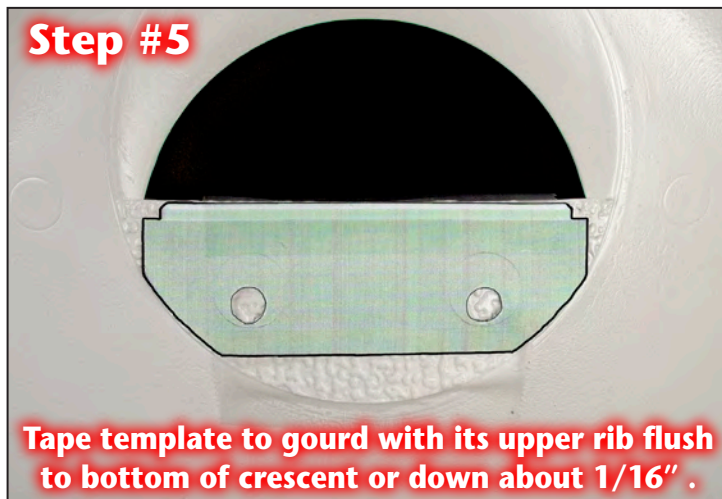

**Step #5**  
Tape template to gourd with its upper rib flush to bottom of crescent or down about 1/16" .



**Step #5 (Continued)**  
Marked drill holes using the template.



**Step #6**  
Drill the centers of the marked (or pre-molded) holes using a 7/32" drill bit.



**Step #6 (Continued)**  
Holes successfully drilled.

**Step #5:** Using clear Scotch Tape on both the top and bottom of the template, attach it below the crescent hole as shown in photo so that it centered beneath the crescent, and the image of the first elevated traction rib is flush with the flat bottom of the hole (or down 1/16"). Using a black Sharpie pen or Magic Marker, make two circular drill marks on the gourd through the circular cut holes. Carefully remove the template for use on the next gourd. Before marking a second gourd, make sure to complete all the mounting steps on the first gourd for trouble-shooting purposes. Future molding runs of the SuperGourd will come with drill locations pre-marked with indentations in the plastic to eliminate the need for a template.

**Step #6:** Use a 7/32" drill bit to drill your two bolt holes where marked or dimpled. Go slow and make sure to drill in the very centers of the dimples or black marks. Drill the two holes perpendicular to the gourd surface and not at an angle.

**Step #7:** Roll the SuperGourd on its side as shown in photo. Put a porch half and two whiz-lock nuts inside the gourd for temporary storage. Grab two of the threaded, 10-32 x 1" bolts (supplied) and push them through the holes in the other half of the porch, then into the holes you just drilled in the gourd, holding them with your fingers as shown. Hold the porch against the gourd se-

curely by pushing on the bolts from the outside. Push the porch and the bolts snug against the gourd for maximum penetration of the bolts. At the same time, reach inside the gourd through the access port and grab the matching inner porch. Look through either the access hole or the crescent hole to mate the two holes on the inner porch with the two bolts. Slide the inner porch half onto the protruding bolts as far as you can. If you keep the gourd rolled onto its side and the entry hole pointed slightly downward, gravity will act as your third hand and allow you to let go of the loose assembly with your inner hand to fish around for one of the two loose whiz-lock nuts you placed inside the gourd. Still holding the two bolt heads with your outside fingers, hand thread a whiz-lock nut on the upper, inner bolt. It should spin on very smoothly. If it gives you cross-threading trouble, you are not square and perpendicular with the nut. Back it off and keep trying by hand. Once you get it started, hand thread it about half way, then do the same with the other bolt and whiz-lock nut. If you have trouble securing the whiz-lock nut because of arthritis, a 10-32 wing-nut will also work.

**Step #8:** Once you have the whiz-lock nuts started, you can reorient the gourd to any direction that is comfortable for your hands and arms. Using a slotted



screwdriver on an outside bolt and your fingers holding onto a matching inside whiz-lock nut, start tightening a bolt with the screwdriver. Not tool is needed on the inside to hold the lock nut. With your fingers you can hold the nut until its inner teeth contact the inside of the porch. At that point it will hold itself.

The 7/32" holes you drilled in your SuperGourd are slightly larger in diameter than the 10-32 bolts so you have a little play to fine tune the level of both the inner and outer porch halves. Level the two porches, side to side, then tighten very securely. The tightened bolts will cause the porch to conform to the curves of the gourd. If necessary, fill in the crevices where the porch halves meet the gourd using white, 100% silicone caulk, so the martins will not get their toes caught. This is especially important if you put porches on a 2-1/8" Round-holed SuperGourd, or Bluebird SuperGourd, as shown on the next page.

Bird Abodes' HD Porches have lots of UV protectant in them so there is no need to paint them for added protection from the sun. However, to maximize the life of all your plastic gourds, caps, and porches, it is recommended that they all be stored out of the sun

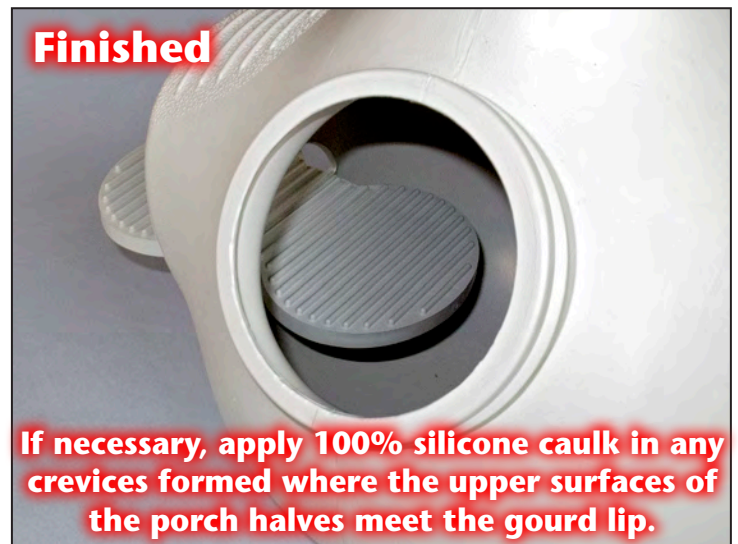

**If necessary, apply 100% silicone caulk in any crevices formed where the upper surfaces of the porch halves meet the gourd lip.**

during the three seasons of the year that they are not hung out for nesting birds. Adding porches to crescent entrances not only gives the martins an inside and outside perch, but it also greatly assists them in negotiating the tight entrance hole. It might also bestow some added protection from owl predation. Be sure to fill the inside of your gourds with several inches of dried pine straw for the martins to use as bedding.

**These porches can also be put on Bluebird and 2-1/8" Round-holed SuperGourds**



[www.SuperGourd.com](http://www.SuperGourd.com)

**Bird Abodes**

506 Erie Street (Pole Barn)

PO Box 756

Edinboro, PA 16412

814-323-2001 (phone)

[info@SuperGourd.com](mailto:info@SuperGourd.com) (e-mail)

[www.SuperGourd.com](http://www.SuperGourd.com)



**Installing Porches on Bluebird and Round-holed SuperGourds**

Although these HD porches were designed for the Crescent-holed SuperGourd, they also can be used on the Bluebird and Round-holed SuperGourd. You still use the cut-out drill template, but place the holes approximately as shown above in Fig. #2 for a Bluebird SuperGourd and Fig. #3 for a the 2-1/8" Round-holed SuperGourd. Notice that at these drill locations, the porches block the bottom of the bluebird hole by about 3 mm and the Round-holed gourd by about 10 mm. This is necessary for the porch to sit level (horizontal) on the front of the gourd and will not affect entry by the species of bird you hope to attract. Unfortunately, adding porches to round-holed gourds will NOT keep out House Sparrows or Starlings, but may potentially add a degree of raccoon and owl protection to the birds inside. **EXTREME CAUTION: A potential, foot-trapping crevice is formed when adding these porches**

to SuperGourds with round holes and you MUST fill in the gap formed by the mating of the inner and outer porch halves with white, 100% silicone caulking.

**Drilling Front-to-Back Hanging Holes in SuperGourds**

**Step #1 (Page 5):** SuperGourds are manufactured with side-to-side hanging holes. In the past, when they were purchased with a gourd rack system (gourds and rack), the customer was provided with enlarged *side-to-side*, hanging holes in their gourds. Now we ship out systems with *front-to-back* enlarged hanging holes and appropriate gourd arms to match. If a previous customer now wishes to have front-to-back hanging holes in their gourds, they can drill them themselves using these instructions and order compatible metal arms or hangers bent 90 degrees differently. Even though our new porches are extremely light weight, once attached, the gourd may hang

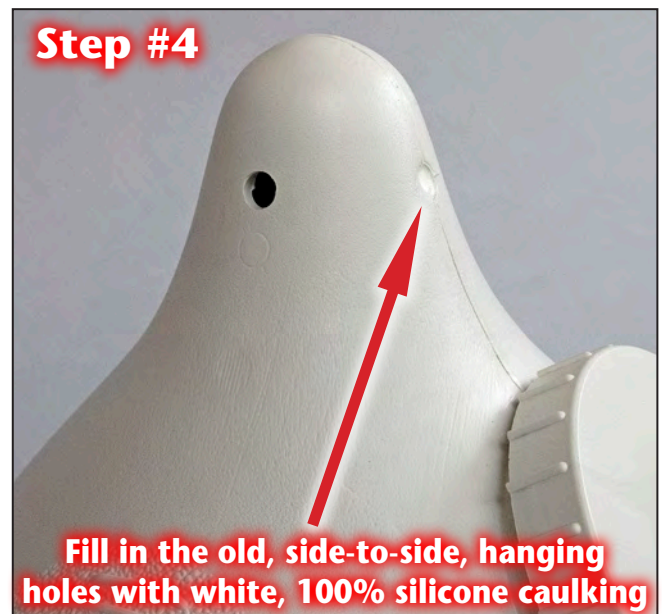
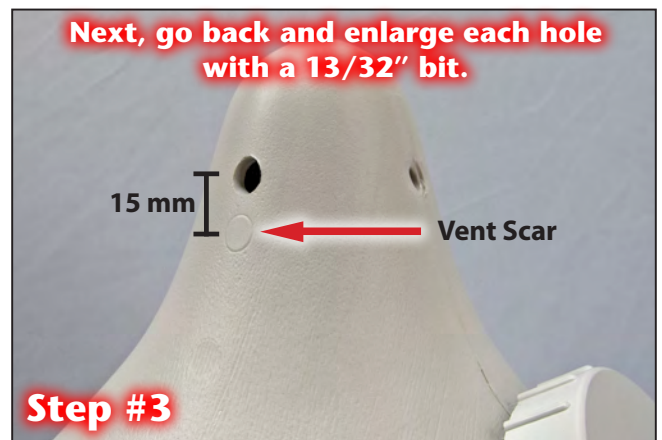
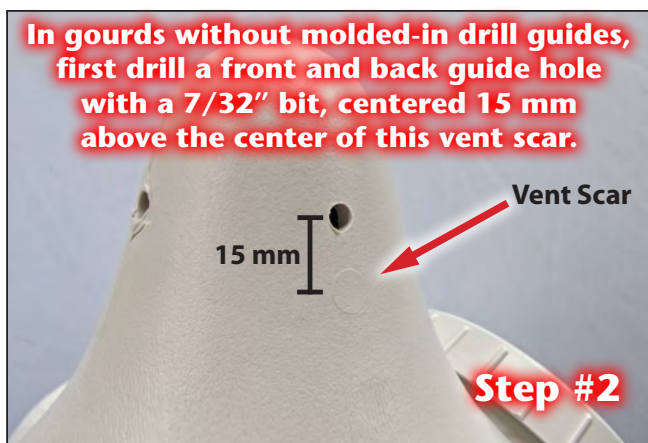
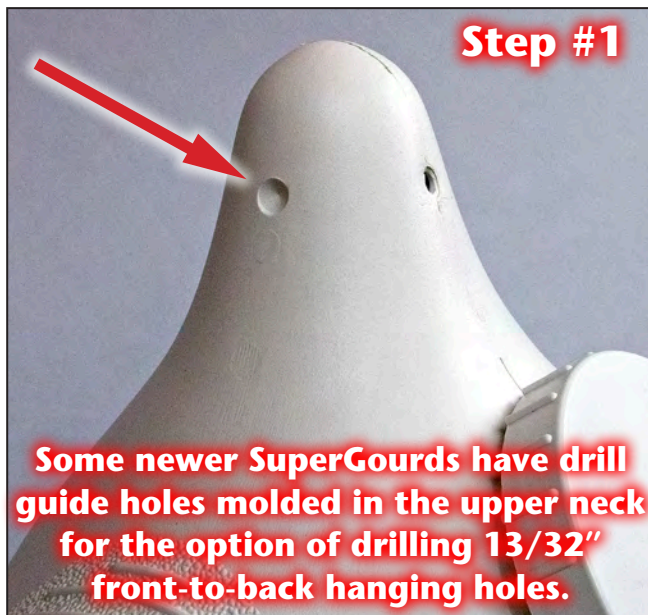

with a slight forward tilt when hung with side-to-side holes. The birds won't mind, but if this is of concern to the landlord, the tilt can be remedied on gourd racks with 3/8" Gourd-mounting Arms (GMAs) or rods by drilling new 13/32" hanging holes in the gourd, front to back and using different GMAs. Some new SuperGourds now come with drill guide holes molded into the upper neck for front-to-back drilling, as shown in the photo for step #1. If you have such a gourd, just drill a 13/32" hole, front and back using the guides (and skip step #2). If your SuperGourds don't have these guides, start at step #2.

**Step #2:** To drill front-to-back hanging holes in an older SuperGourd without drill guide indentations,

drill 15 mm above the centers of the circular vent scars on the front and back of the SuperGourd's neck. The arrows in Steps #2 and #3 indicate these circular vent scars. Initially, drill each hole with a 7/32" drill bit to establish an accurate guide hole. First drill the front, then drill the back.

**Step #3:** Follow up with a 13/32" drill bit in your two front-to-back guide holes. It is very important to angle the drill towards the matching hole on the opposite side of the neck. You want the 3/8" diameter GMAs (or gourd arms) to be able to slide through these holes.

**Step #4: IMPORTANT:** To prevent water entry, patch the two, unused, side holes with white, 100% silicone caulking.

**Identical Drill Templates for Mounting SG-HDPORCHES to SuperGourds \*\***

**\*\* Make sure your printer or photocopier didn't change the size of these porch photos. They must be the same size as the actual porches, 74 mm wide, and the drill holes in the photos perfectly align with the bolt holes in the plastic porches.**

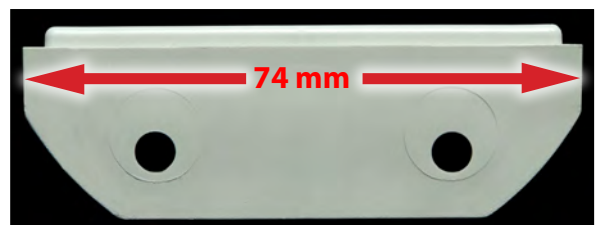
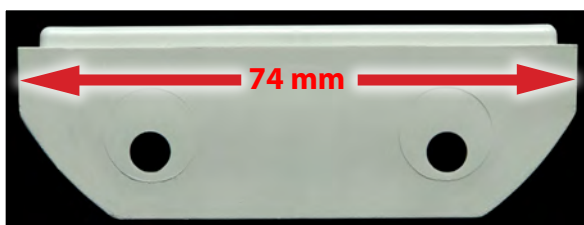



***A subadult male Purple Martin on his porched, round-holed SuperGourd***



***A 6-egg Purple Martin clutch inside a porched, crescent-holed SuperGourd***